

**EPSX10A**  
**EPSX14A**  
**EPSXB10A**  
**EPSXB14A**

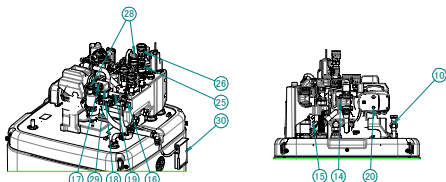

Basic unit - 300-1

View with option

Basic unit - 500-1

View with option

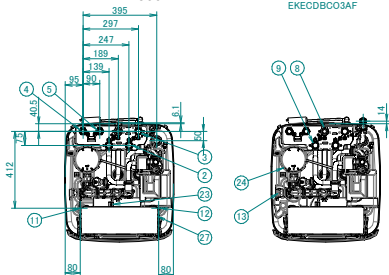

Front view  
 All options - 300-1

Side view

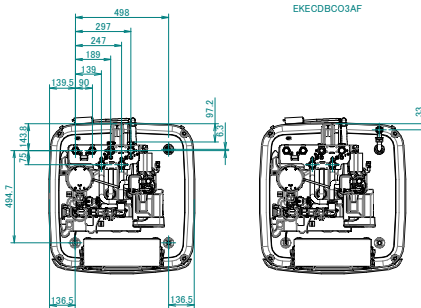

Front view  
 All options - 500-1

Side view

- ① User interface
- ② Space heating/cooling - Water IN
- ③ Space heating/cooling - Water OUT
- ④ Domestic hot water: cold water in
- ⑤ Domestic hot water: hot water out
- ⑥ Water IN from bivalent heat source
- ⑦ Water OUT to bivalent heat source
- ⑧ Water IN from outdoor unit
- ⑨ Water OUT to outdoor unit
- ⑩ Drainback solar - Water IN
- ⑪ Tank thermistor
- ⑫ Level indicator
- ⑬ DHW tank mixing 3-way valve
- ⑭ Bypass mixing 3-way valve
- ⑮ Flow sensor
- ⑯ Fill valve
- ⑰ Safety valve
- ⑱ Expansion vessel connection - G3/8"
- ⑲ Space heating water pressure sensor
- ⑳ Pump
- ㉑ Drain pan
- ㉒ Spillover connection
- ㉓ Backup heater switch box
- ㉔ Backup heater
- ㉕ Shut-off valve - 1"-1 1/4" (male-female)
- ㉖ Shut-off valve normally closed - QC female - 1 1/4" female
- ㉗ Switch box (main)
- ㉘ Automatic air purge valve
- ㉙ Separator box
- ㉚ Gas sensor box

Rear view

Rear view

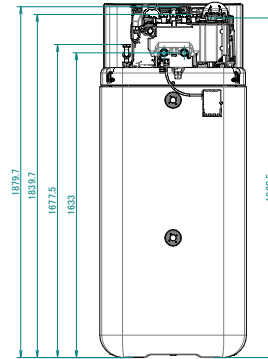
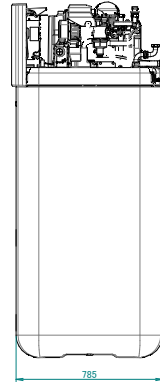
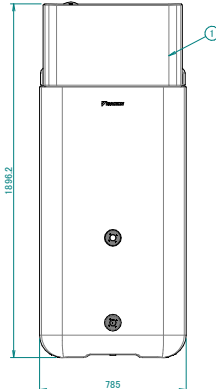
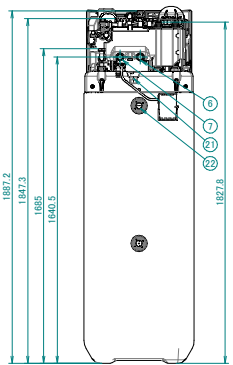
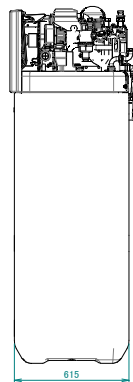
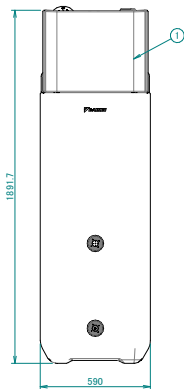

The typical field installation has to be done according to the applicable legislation.  
 For examples, refer to the installer reference guide.