

# FXDA63A

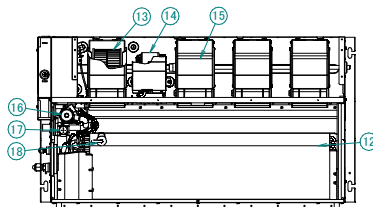
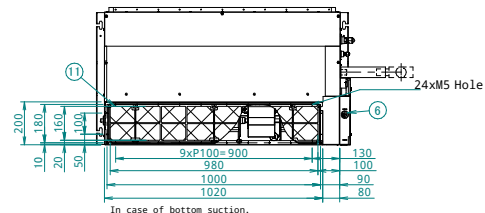
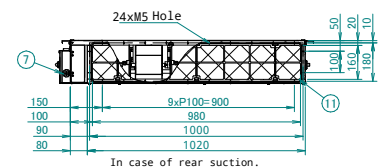
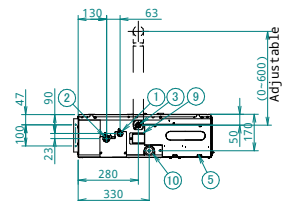
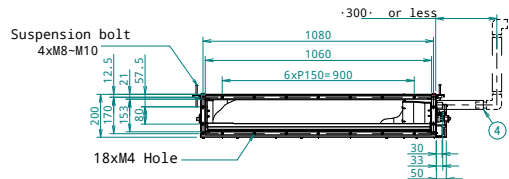
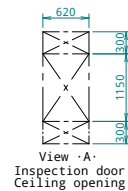
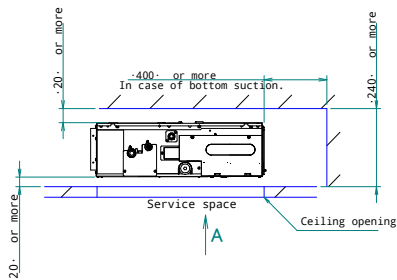
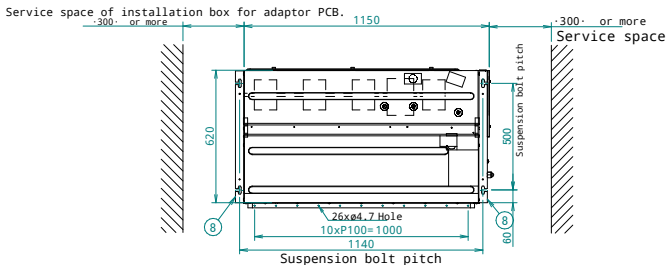

Item		
1	Liquid pipe connection ·ø6.35·	Flare connection
2	Gas pipe connection ·ø12.70·	Flare connection
3	Drain pipe connection	Outside diameter: ·ø26· Inside diameter: ·ø20·
4	Drain hose (accessory)	Inside diameter: ·ø25·
5	Control box	
6	Transmission wiring connection	
7	Power supply connection	
8	Suspension bracket	
9	Inspection door	
10	Drain socket	
11	Air filter (accessory)	
12	Heat exchanger	
13	Turbo fan	
14	Fan motor	
15	Fan housing	
16	Drain pump	
17	Float switch	
18	Electronic expansion valve	

## Notes

- In case of bottom suction, mount the chamber cover to the backside of the unit.  
For more information, refer to the installation manual.
- In case of rear suction, mount the chamber cover to the bottom side of the unit.  
For more information, refer to the installation manual.
- The unit nameplate is located on the control box cover.
- Mount the air filter at the suction side.  
Use an air filter with a dust collecting efficiency of at least ·50·% (measured by gravimetric analysis).  
When a duct is connected at the suction side, it is not possible to mount an air filter.